

**K-Lock Nut (With Free-Spinning External Tooth Lockwasher)**

**METRIC**

**Nuts**

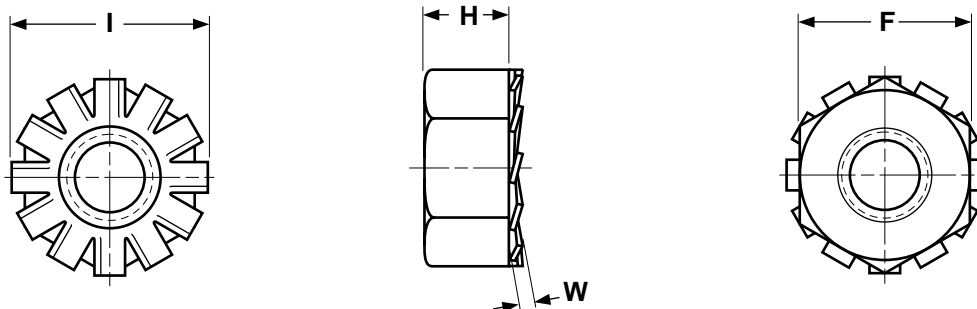

METRIC - K-LOCK NUTS, CLASS 8						DIN 934K
Nominal Size	Thread Pitch	F	H	T	I	W
		Width Across Flats	Nut Thickness	Total Thickness (Nut w/assembled washer)	Width of Washer	Washer Thickness
M3	0.50	5.5	2.40	3.20	6.30	0.45
M4	0.70	7	3.20	4	8	0.45
M5	0.80	8	4	5.10	9.20	0.60
M6	1	10	5	6.10	11.0	0.60
M8	1.25	13	6.50	7.90	14.90	0.80
M10	1.50	17	8	9.60	19	0.90

Description	A hex nut with metric thread pitch, pre-assembled with a free spinning external tooth lock washer. The locking action is achieved when the nut is tightened against a bearing surface as the teeth of the lock washer dig into it.
Applications/Advantages	This is the most popular type of locknut because of its versatility, cost and ease of installation. Doesn't gall screw threads.
Material	Nuts shall be made from a low carbon steel which conforms to the following chemical composition requirements-- <i>Carbon:</i> 0.58% maximum; <i>Manganese:</i> 0.25% minimum; <i>Phosphorous:</i> 0.060% maximum; <i>Sulfur:</i> 0.150% maximum; Washers-- Spring steel.
Hardness	Nuts-- <u>M3 - M4</u> : Vickers HV 180 - 302 (Rockwell B87.1 - C30); <u>M5 - M10</u> : Vickers HV 200 - 302 (Rockwell B91.5 - C30) Washers-- Rockwell C 41 - 47
Plating	See Appendix-A for information about the plating of steel nuts.